



**Precision equipment for sanding. Small and comfortable.
Die-cast aluminum heads.**

Belt Sander BS/E

For shape finishing, mortising, fine polishing (flat surfaces). Also for de-burring metal, paint removal and fine finishing.



A light, compact and user-friendly unit that makes sanding in tight spaces more convenient. Used in modeling, sculpturing, tool- and die-making or the automotive sector. The belt sander has a speed control for variable speeds from 12 - 25ft/s (225 - 450m/min), which enables to work on many different materials, such as wood, metal or plastic. It can be used for grinding and enlarging small openings, grinding in notches, regrinding moulds or polishing (flat surfaces). It is also great for deburring, rounding edges or removing paint. Recentering or tilting the belt is easily done with a screwdriver.

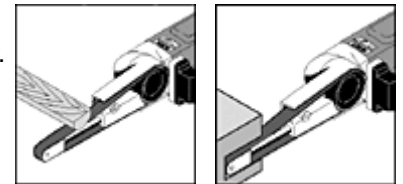

The belt arm itself is adjustable within an angle of 60° by the push of a button on the head.

Technical data:

Volts	110 - 120V AC, 60Hz
Max. Power	1/8hp (100W)
Belt Speed	12 - 25ft/s (225 - 450m/min)
Length	13 3/4" (350mm)
Weight	1.4 lb (650g)
Belt Size	13" x 13/32" (330 x 10mm)

Comes with two 80 grit and two 180 grit sanding belts.

NO 38 536

Replacement Sanding Belts for Belt Sander BS/E

Made from high-quality aluminum-oxide on tough, woven, lightweight cloth backing. For sanding metal, non-ferrous metal, wood and plastic.



NO 28 583	80 grit	set of 5
NO 28 582	120 grit	set of 5
NO 28 581	180 grit	set of 5

Silicon Carbide Sanding Belt

For use on glass, ceramics, brass, steel and cast iron.

NO 28 579	180 grit	set of 5
------------------	----------	----------



 Video BS/E



Storage case of high-grade PP. Attractive, extremely stable and large enough to enable the machine to be replaced in it after completion of the work. A label on the side identifies the content.